



Australia's leading supplier of container doors, security doors, emergency exits & PA doors

We supply competitively priced steel doors and fire exit doors with unrivalled quality for the container, commercial, industrial & residential sectors



Container Doors

Our container doors have been designed specifically for this industry, offering a range of solutions for any kind of container conversion, temporary buildings and more. They all have a fully welded construction and sealed joints, finished in a high quality polyester powder coat finish or wet sprayed with a grey primer finish, ready for final coat on-site.

Featuring either our HOOPLY™ multi point locking system, or flush lock handles, they have thermal and acoustic insulation along with weather seals included as standard.



Goal Post Frames

50 x 100mm / 2x4" steel box section,
2.5mm mild steel cold formed
rectangular hollow section

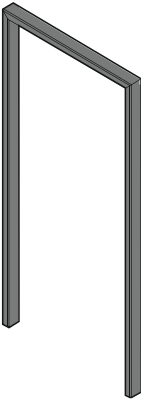

Door Sets & Styles



Box Frame Container Door (Weld in)

DOOR SIZE	820 x 2060mm (934 x 2115mm Frame) 920 x 2060mm (1034 x 2115mm Frame) 1020 x 2060mm (1134 x 2115mm Frame)
DOOR LEAF DEPTH	45mm
MATERIAL & GAUGE	Double skinned 1.0mm galvanised steel
FRAME DEPTH	115mm
FRAME MATERIAL	1.4mm Galvanised Steel
DOOR LEAF CORE	High Density Polyurethane Foam Insulation



Standard Container Door & Frame

DOOR SIZE	820 x 2040mm (874 x 2053mm Frame) 920 x 2040mm (974 x 2053mm Frame)
DOOR LEAF DEPTH	35mm
MATERIAL & GAUGE	Double skinned 0.8mm galvanised steel
FRAME DEPTH	80mm
FRAME MATERIAL	1.4mm Galvanised Steel
DOOR LEAF CORE	High Density Polyurethane Foam Insulation



Heavy Duty Container Door & Frame

DOOR SIZE	840 x 2020mm (910 x 2065mm Frame)
DOOR LEAF DEPTH	45mm
MATERIAL & GAUGE	Double skinned 1.0mm galvanised steel
FRAME DEPTH	90mm
FRAME MATERIAL	2.0mm Galvanised steel
DOOR LEAF CORE	High Density Polyurethane Foam Insulation

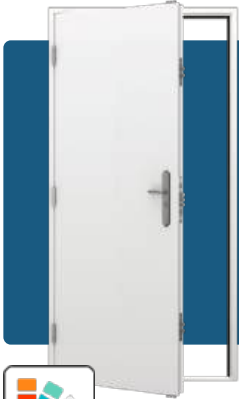

Ablution Unit Toilet Door

DOOR SIZE	720 x 2050mm (790 x 2095mm Frame) 820 x 2050mm (890 x 2095mm Frame) 920 x 2050mm (990 x 2095mm Frame) 1020 x 2050mm (1090 x 2095mm Frame) 1120 x 2050mm (1190 x 2095mm Frame)
DOOR LEAF DEPTH	45mm
MATERIAL & GAUGE	Double skinned 0.8mm galvanised steel
FRAME DEPTH	90mm
FRAME MATERIAL	1.4mm Galvanised Steel
DOOR LEAF CORE	High Density Polyurethane Foam Insulation



Container Windows

Our container shutters and glazing units are a great way to add additional light and ventilation to a container or modular building or add additional protection against attacks.

Our shutters include 4 internal flush bolts that are simple but effective in securing the door leaves within the frame. We also offer an easy to install Aluminium single/double glazed units to fit with it, or in additional larger sizes, with optional security grille & mesh options.

Goal Post Frames

50 x 100mm / 2x4" steel box section,
2.5mm mild steel cold formed
rectangular hollow section

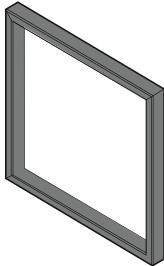

Window Sets & Styles



Container Window Shutter

SHUTTER SIZE	1200 x 1000mm
WINDOW DEPTH	45mm
MATERIAL & GAUGE	Double Skinned 1.0mm Galvanised Steel
INSULATION	115mm
FRAME DEPTH	90mm
MATERIAL & GAUGE	2.0mm Galvanised Steel



Window Security Upgrades

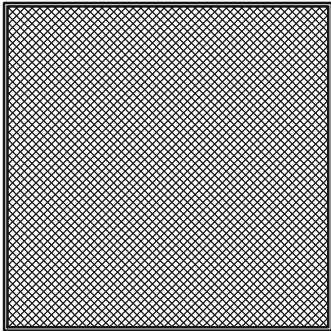

Security Grille

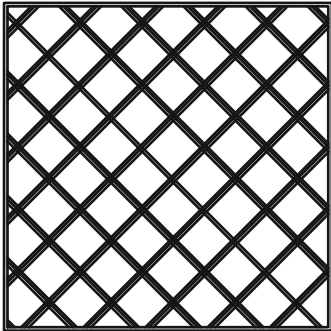

Security Mesh



Shipping Container Window

WINDOW SIZE	912 x 912mm 1200 x 1000mm 2000 x 1000mm
FRAME MATERIAL	Aluminium
GLAZING TYPE	Double Glazed
FLY SCREEN	Integrated
FLIP CATCHES	Integrated
FIXING TYPE	Face fix



Hatches & Grilles

Our container air relief grilles and access hatches offer practical solutions for access or effective air transfer in modified shipping containers.

Access hatches are pre-hung in a welded frame with sealed joints. Each hatch includes a flush lock handle and is finished in Surfmist White, ensuring a sleek, and simple face-fix installation. Ideal for container modifications like plant rooms, boiler houses, and customer service points.

Flush lock example



Door Sets & Styles



Container Access Hatch

HATCH SIZE	623 x 720mm (677 x 733mm Frame)
HATCH LEAF DEPTH	35mm
MATERIAL & GAUGE	Double skinned 0.8mm galvanised steel
FRAME DEPTH	80mm
FRAME MATERIAL	1.4mm Galvanised steel
HATCH LEAF CORE	High Density Polyurethane Foam Insulation



Container Wall Air Relief Grille

GRILLE SIZE	479 x 479mm 479 x 1546mm 600 x 600mm
GRILLE DEPTH	50mm
BLADE TYPE	Fixed
MATERIAL	Galvanised steel
AIRFLOW	Up to 50%
FINISH	Polyester powder coat (suitable for painting)

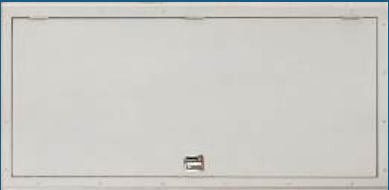

Container Wall Hatch

HATCH SIZE	820 x 2040mm (874 x 2053mm Frame) 920 x 2040mm (974 x 2053mm Frame)
HATCH LEAF DEPTH	35mm
MATERIAL & GAUGE	Double skinned 0.8mm galvanised steel
FRAME DEPTH	80mm
FRAME MATERIAL	1.4mm Galvanised steel
HATCH LEAF CORE	High Density Polyurethane Foam Insulation

Goal Post Frames

50 x 100mm / 2x4" steel box section, 2.5mm mild steel cold formed rectangular hollow section

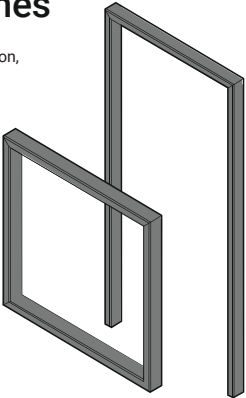



Our steel shed doors, donga doors and aluminium sliding shed windows are perfect for a wide range of uses, from steel sheds, garages, dongas, modular buildings and many more.

Designed for use in outdoor structures, our doors are easy to install and available with a range of Dormakaba handle options. Our double glazed aluminium windows are available in 3 sizes, with a large flange for fast & easy installation, and integrated fly screen. An optional security grille or mesh is also available for added peace of mind.

Donga Door Handle Options

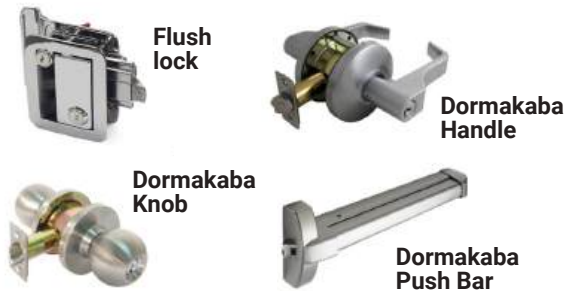

Door Sets & Styles

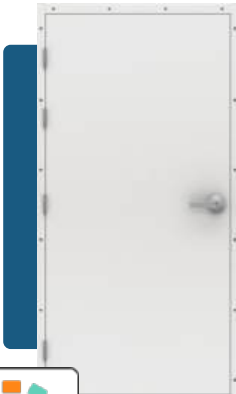

Donga/Shed PA Door & Frame

DOOR SIZE	820 x 2040mm (890 x 2095mm Frame) 920 x 2040mm (990 x 2095mm Frame) 1020 x 2040mm (1090 x 2095mm Frame)
DOOR LEAF DEPTH	45mm
MATERIAL & GAUGE	Double skinned 0.8mm galvanised steel
FRAME DEPTH	90mm
FRAME MATERIAL	1.4mm Galvanised Steel
DOOR LEAF CORE	Mineral wool insulation



Donga/Shed Fire Exit Door

DOOR SIZE	820 x 2040mm (890 x 2095mm Frame) 920 x 2040mm (990 x 2095mm Frame) 1020 x 2040mm (1090 x 2095mm Frame)
DOOR LEAF DEPTH	45mm
MATERIAL & GAUGE	Double skinned 0.8mm galvanised steel
FRAME DEPTH	90mm
FRAME MATERIAL	1.4mm Galvanised Steel
DOOR LEAF CORE	Mineral wool insulation

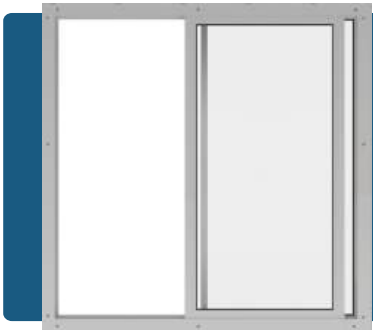

Double Glazed Shed Window

WINDOW SIZE	912 x 912mm 1200 x 1000mm 2000 x 1000mm
FRAME MATERIAL	Aluminium
GLAZING TYPE	Double Glazed
FLY SCREEN	Integrated
FLIP CATCHES	Integrated
FIXING TYPE	Face fix

Goal Post Frames

50 x 100mm / 2x4" steel box section, 2.5mm mild steel cold formed rectangular hollow section

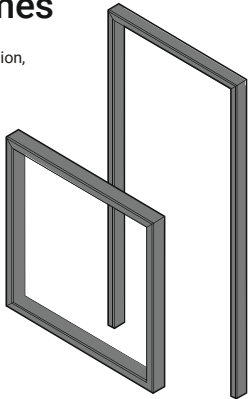



Steel Security Doors

Perfect for securing any kind of property, our high security doors feature a thicker grade of steel on the door leaf and frame, a denser mineral wool core and further internal strengthening when compared with our standard duty version. With our HOOPLY™ 19-point locking system included as standard also, it's an unrivalled security door to secure your home or business.

Supplied pre-finished in a Surfmist powder coat, all locks, hinges and hardware are pre-installed as standard, ready to install straight out of the box.

Default Handle
Hooply handles (918901)





Door Sets & Styles



Single Steel Security Door & Frame

DOOR SIZE	720×2050 (790×2095 Frame) 820×2050 (890×2095 Frame) 840×2020 (910×2065 Frame) 920×2050 (990×2095 Frame) 1020×2050 (1090×2095 Frame) 1120×2050 (1190×2095 Frame)
DOOR LEAF DEPTH	50mm
MATERIAL & GAUGE	Double skinned 1.0mm galvanised steel
FRAME DEPTH	90mm
FRAME MATERIAL	1.8mm Galvanised Steel
DOOR LEAF CORE	Mineral wool insulation



Double Steel Door & Frame

DOOR SIZE	710×2050*2 (1490×2095 Frame) 860×2050*2 (1790×2095 Frame) 1010×2050*2 (2090×2095 Frame)
DOOR LEAF DEPTH	50mm
MATERIAL & GAUGE	Double skinned 1.0mm galvanised steel
FRAME DEPTH	90mm
FRAME MATERIAL	1.8mm Galvanised Steel
DOOR LEAF CORE	Mineral wool insulation



Emergency Exit Doors

Our fire escape doors offer a reliable, cost-effective solution for emergency exits and fire safety compliance. Pre-fitted with UK-made Exidor panic hardware, they ensure dependable performance in emergencies.

Pre-hung in frames and fully galvanised for durability, with stainless steel hinges for internal or external use.

Available in single and double sizes, ideal for enhancing fire safety in commercial or industrial premises.

Outer Access Device Options

Exidor 322
Outside Access
Device



Rimlock



Door Sets & Styles



Single Fire Exit Door & Frame

DOOR SIZE	820×2050 (890×2095 Frame), 920×2050 (990×2095 Frame)
DOOR LEAF DEPTH	45mm
MATERIAL & GAUGE	Double skinned 8.0mm galvanised steel
FRAME DEPTH	90mm
FRAME MATERIAL	1.4mm Galvanised Steel
DOOR LEAF CORE	Honeycomb core



Double Fire Exit Door & Frame

DOOR SIZE	860×2050*2 (1790×2095 Frame)
DOOR LEAF DEPTH	45mm
MATERIAL & GAUGE	Double skinned 0.8mm galvanised steel
FRAME DEPTH	90mm
FRAME MATERIAL	1.4mm Galvanised Steel
DOOR LEAF CORE	Honeycomb core



Security Front Doors

Our steel-framed security front doors provide peace of mind without compromising your home's aesthetic. Available in sleek designs with customizable options like glazing, door furniture, and colors, they balance security and style.

Pre-hung on steel frames with fixings and hardware included, they feature a multi-point locking mechanism and optional security upgrades, making them ideal for securing your premises.

Default Handle
Hooply handles (918901)



Door Sets & Styles



Security Front Door

DOOR SIZE	720×2050 (790×2095 Frame) 820×2050 (890×2095 Frame) 920×2050 (990×2095 Frame) 1020×2050 (1090×2095 Frame) 1120×2050 (1190×2095 Frame)
DOOR LEAF DEPTH	50mm
MATERIAL & GAUGE	Double skinned 1.0mm galvanised steel
FRAME DEPTH	90mm
FRAME MATERIAL	1.8mm Galvanised Steel
DOOR LEAF CORE	Mineral wool insulation

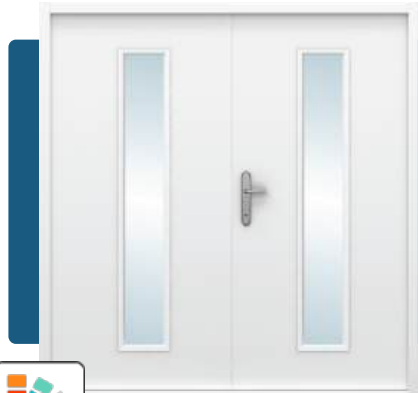

Double Security Front Door & Frame

DOOR SIZE	710×2050*2 (1490×2095 Frame), 860×2050*2 (1790×2095 Frame), 1010×2050*2 (2090×2095 Frame)
DOOR LEAF DEPTH	50mm
MATERIAL & GAUGE	Double skinned 1.0mm galvanised steel
FRAME DEPTH	90mm
FRAME MATERIAL	1.8mm Galvanised Steel
DOOR LEAF CORE	Mineral wool insulation



Air Vent Doors

Our Steel Air Vent Doors are expertly designed to meet the needs of spaces requiring a combination of airflow, ventilation, and security. Suitable for both internal and external applications, they are an ideal solution for plant rooms, boiler rooms, server rooms, bin stores, and various other industrial or commercial environments.

These doors provide exceptional ventilation, offering up to 50% airflow to regulate temperatures efficiently in areas prone to overheating. The purpose-built air relief grilles are designed to

promote effective airflow while maintaining security against unauthorised access.

Built for strength and reliability, these doors are fitted with our industry-leading 19-point locking system, making them some of the strongest air vent doors available in Australia. They are supplied pre-hung on robust frames, with all fixings and hardware included, ensuring quick and hassle-free installation.

Door Sets & Styles

Steel Air Vent Door & Frame

DOOR SIZE	820×2050 (890×2095 Frame) 920×2050 (990×2095 Frame) 1120×2050 (1190×2095 Frame)
DOOR LEAF DEPTH	45mm
MATERIAL & GAUGE	Double skinned 0.8mm galvanised steel
FRAME DEPTH	90mm
FRAME MATERIAL	1.4mm Galvanised Steel
DOOR LEAF CORE	Honeycomb core

Steel Air Vent Double Door & Frame

DOOR SIZE	710×2050*2 (1490×2095 Frame) 860×2050*2 (1790×2095 Frame) 1010×2050*2 (2090×2095 Frame)
DOOR LEAF DEPTH	45mm
MATERIAL & GAUGE	Double skinned 0.8mm galvanised steel
FRAME DEPTH	90mm
FRAME MATERIAL	1.4mm Galvanised Steel
DOOR LEAF CORE	Honeycomb core

Handle & Lock Range



HOOPLY 918901
Handle



HOOPLY Toilet
Indicator Handle



HOOPLY 2168 Door
Knob



HOOPLY Black Lever
Handle



Flush Mounted Door
Handle



One Motion Escape
Handle + Lock



Thumb Turn Euro
Cylinder



HOOPLY Lock/Gearbox



Door Sill



Expanding Side Panels



Over Head Panels



Security Trim

Accessories:



Air Relief Grille



Viewing Panel



Kick Plates



Push Plates

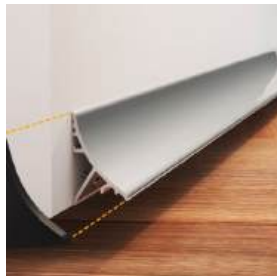

Rain Deflector



Wind Out Lugs



Weldable Hinges



Panic Hardware

Frame Extensions



Door Sill



Expanding Side Panels



Over Head Panels



Security Trim

Visit us online to view our full range of
steel doors & accessories

- Container doors & windows
- Steel security doors
- Fire escape doors
- Shed & donga doors
- Residential doors
- Air vent doors
- Hooply handles & locks
- Exidor panic hardware
- Doors & shutter parts
- Weldable hinges

www.lathamssteeldoors.com.au





Latham's[®]

STEEL DOORS AUSTRALIA



58 Wellard Street, Bibra Lake
WA 6163



+61 426 899 119



sales@lathamssteeldoors.com.au



www.lathamssteeldoors.com.au



Google Rating

5.0 ★★★★★